

INDEPENDENCE SUBDIVISION FILING NO.S 1, 2, 3, 4, 5 & HOMESTEAD PLAT AMENDMENT

THE WEST HALF AND THE SOUTHEAST QUARTER OF SECTION 14 & ALL OF SECTION 15, TOWNSHIP 7 SOUTH, RANGE 65 WEST OF THE 6TH P.M.,
COUNTY OF ELBERT, STATE OF COLORADO

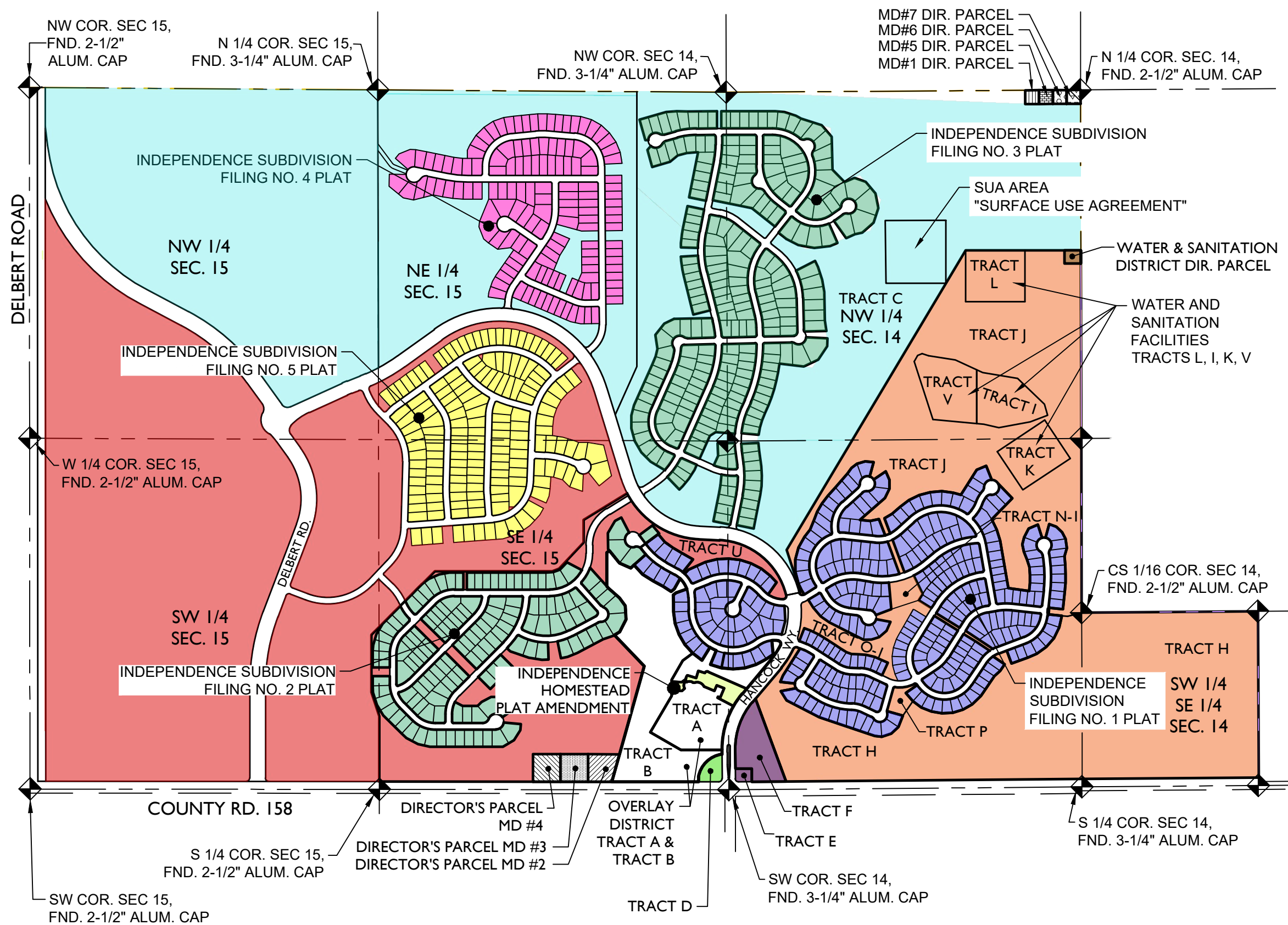

LEGEND

- DIRECTOR'S PARCEL - METROPOLITAN DISTRICT #1 & OVERLAY
- DIRECTOR'S PARCEL - METROPOLITAN DISTRICT #2
- DIRECTOR'S PARCEL - METROPOLITAN DISTRICT #3
- DIRECTOR'S PARCEL - METROPOLITAN DISTRICT #4
- DIRECTOR'S PARCEL - METROPOLITAN DISTRICT #5
- DIRECTOR'S PARCEL - METROPOLITAN DISTRICT #6
- DIRECTOR'S PARCEL - METROPOLITAN DISTRICT #7
- DIRECTOR'S PARCEL - WATER & SANITATION DISTRICT
- METROPOLITAN DISTRICT #1 (PLATTED LOTS)
- METROPOLITAN DISTRICT #2 (PLATTED LOTS)
- METROPOLITAN DISTRICT #4 (PLATTED LOTS)
- METROPOLITAN DISTRICT #5 (PLATTED LOTS)
- PARCEL 2 - TRACT D
- PARCEL 3 - TRACTS E AND F
- PARCEL 4 - TRACTS H, I, J, K, L, N-1, P & V
- PARCEL 5 - TRACT T-3 AND TRACTS B, C & E
- PARCEL 6
- COMMERCIAL DISTRICT